

FOR LEASE | LOWER LEVEL RETAIL/OFFICE SPACE
78 RICHMOND STREET EAST
TORONTO | ON



METROPOLITAN
COMMERCIAL





AERIAL

78 RICHMOND STREET EAST | FOR LEASE



DETAILS

Unit Size	2,778 SF (divisible into two units - 968 SF and 1,810 SF)
Base Rent	Option A - 2,778 SF unit - \$10,418/month or \$45 PSF/YR Option B - 1,810 SF unit - \$6,100/month or \$45 PSF/YR Option C - 968 SF unit - \$3,953/month or \$49 PSF/YR
Additional Rent	Utilities
Term	5 Years
Possession	March 2020

FEATURES

With 35 feet of frontage on the north side of Richmond Street East, the subject property is situated one block east of Yonge St and within a short 400m walk of the TTC Queen and King subway stations. Recent condo developments have added many residences to the existing office buildings, thereby creating both a daytime and evening customer base. With a variety of permitted commercial uses, the property is ideal for medical practices, professional service firms, cafés and eating establishments.

Located on the lower level of a 15-unit brick & beam office building with over 100 daytime employees, the unit will further benefit from the possibility of installing street-front signage for increased visibility and brand awareness. The building's security features include controlled access, CCTV cameras and indoor bicycle parking.



Rider's Paradise
World-class public transportation.



Walker's Paradise
Daily errands do not require a car.

78 RICHMOND STREET EAST | FOR LEASE



78 Richmond Street East

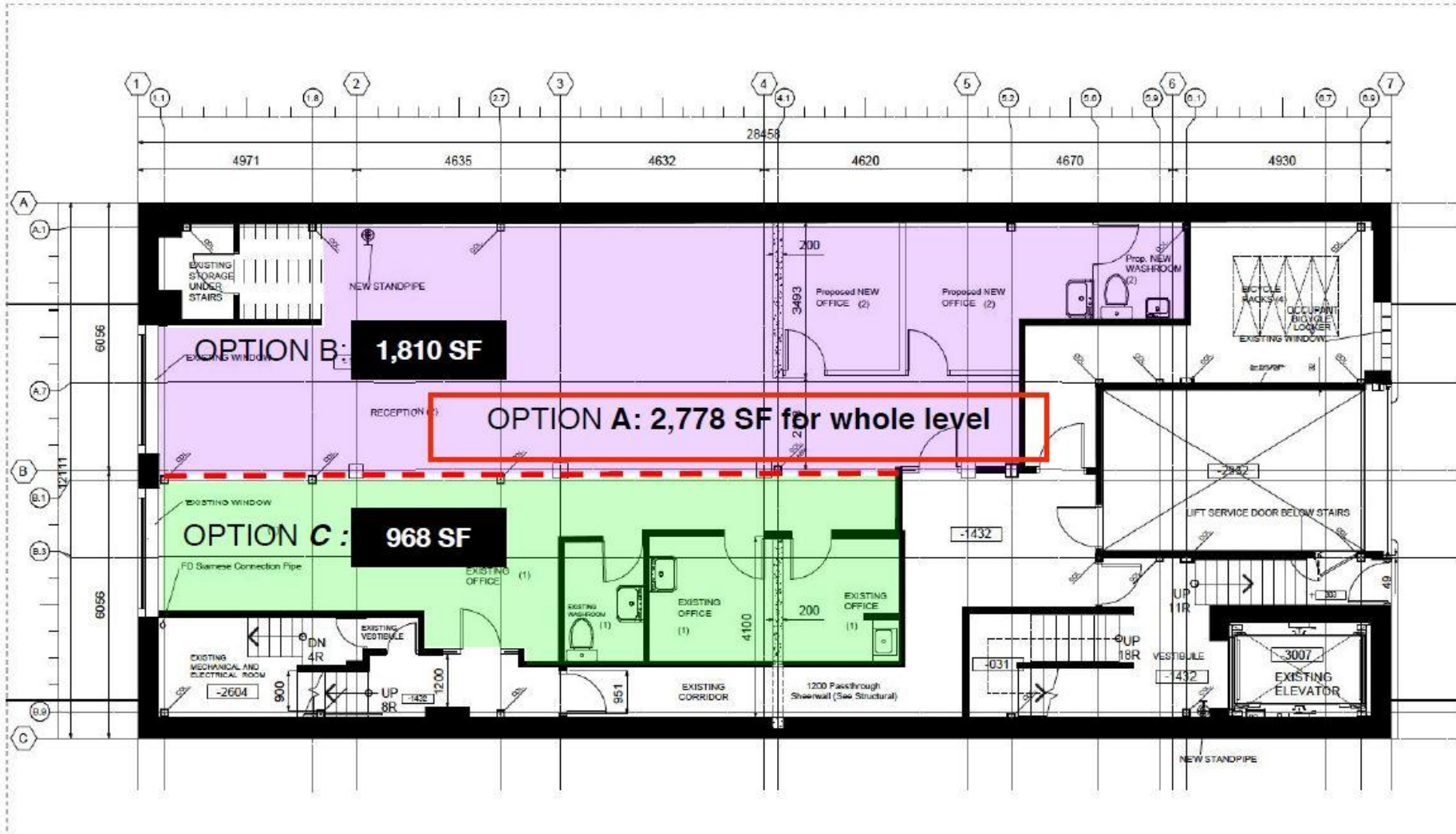

FLOOR PLAN



METROPOLITAN COMMERCIAL

626 King St West, Suite 302
Toronto, ON
M5V 1M7

www.metcomrealty.com

CONTACT:

Kevin Tuttle*	416.703.6621 x 227	kevin.tuttle@metcomrealty.com
Amir Nourbakhsh*	416.703.6621 x 252	amir@metcomrealty.com
Jesse Roth*	416.703.6621 x 243	jesse.roth@metcomrealty.com