

FOR LEASE | OFFICE SPACE | UNIT 807 & 809

130 QUEENS QUAY AVENUE EAST

TORONTO | ON



METROPOLITAN
COMMERCIAL





DETAILS

Location	Queens Quay Avenue East, just East of Lower Jarvis Street Click Here for Map
Building Area	1,940 SF
Semi-Gross Rental Rate	\$11,500.00 / Month
Additional Rent	Utilities + HST
Term	3-5 Years
Possession	August 1 st , 2020

FEATURES

- Two combined beautifully finished units in office building.
- Units consist of 10 offices, 2 separate boardrooms, a reception and kitchenette.
- Offers 12 separate work areas for increased worker isolation is required.
- Access to the buildings amenities such as an exquisite indoor / outdoor rooftop, common space which includes boardrooms, outdoor BBQ and stunning views of the Toronto Harbour and Islands.
- Close proximity to Loblaws and Sugar Beach.
- Close to major highways such as the Gardiner Expressway and Don Valley Parkway.
- An 8 minute bus ride to Union TTC Station.

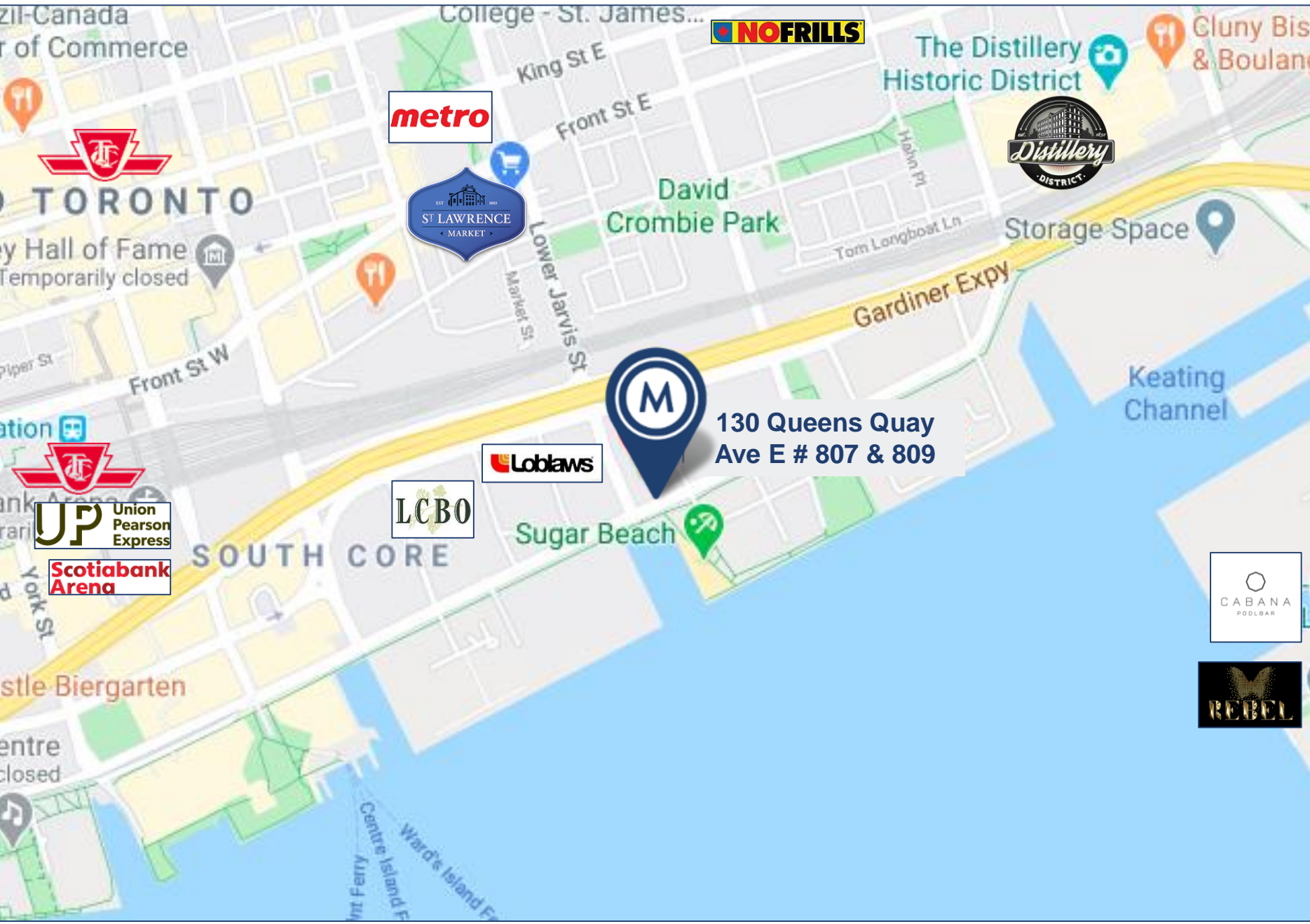

130 Queens Quay
Ave E # 807 & 809



AREA MAP

130 QUEENS QUAY AVENUE EAST - UNIT 807 & 809 | FOR LEASE



UNIT PHOTOS





BUILDING PHOTOS



130 QUEENS QUAY AVENUE EAST - UNIT 807 & 809 | FOR LEASE

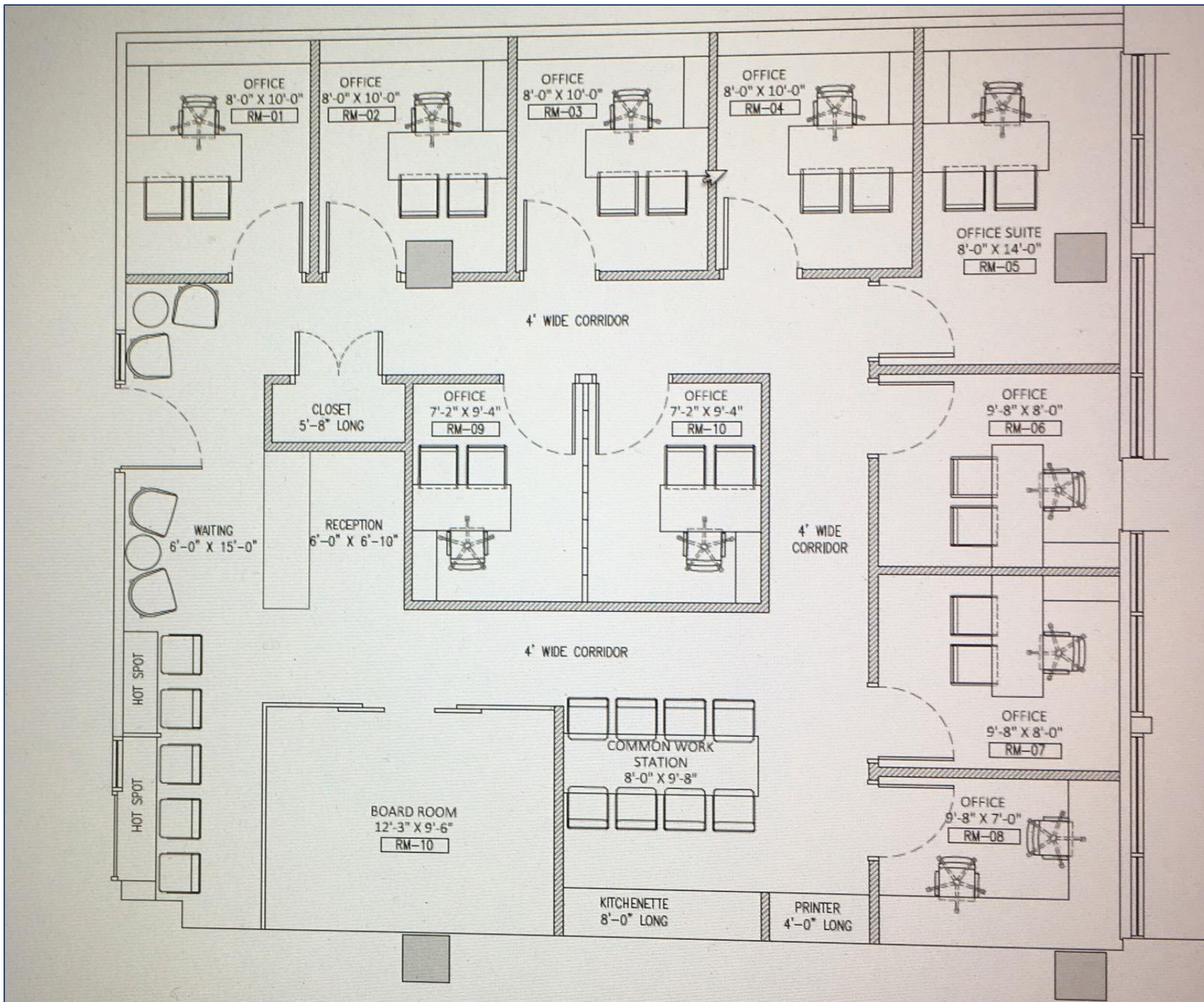

FLOOR PLANS



METROPOLITAN COMMERCIAL

626 King St West, Suite 302
Toronto, ON
M5V 1M7

www.metcomrealty.com

CONTACT:

PAUK KOTYK*
M. 416.890.0324
W. 416.703.6621 ext. 245
paul.kotyk@metcomrealty.com