

**FOR SUBLEASE**  
**658 Danforth Ave**  
Office Space



**METROPOLITAN  
COMMERCIAL**

## PROPERTY DETAILS

LOCATION	West of Pape Avenue on the Northside of Danforth Avenue. <a href="#"><u>CLICK HERE</u></a>
BUILDING DETAILS	Suite 303 - 526 SF
RENTAL RATE	\$19.50 PSF/YR
T.M.I.	\$18.49 PSF/YR
POSSESSION	Immediate

## PROPERTY SUMMARY

- Professional office located steps away from Pape Subway Station.
- Sublet term to November 30 2028.
- Close proximity to a variety of restaurants and amenities.
- Extended term considered.



# FLOOR PLAN

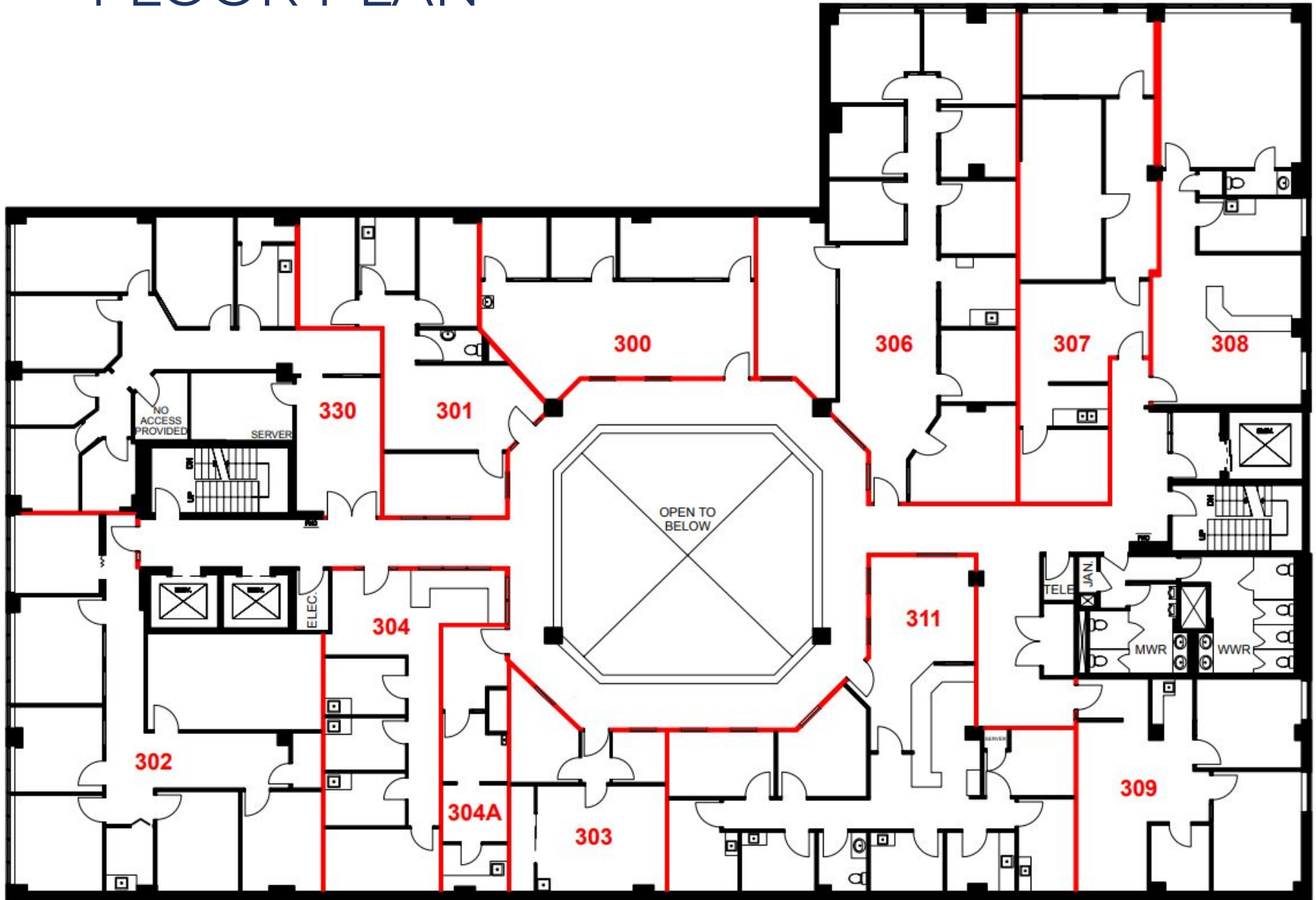

# AREA MAP

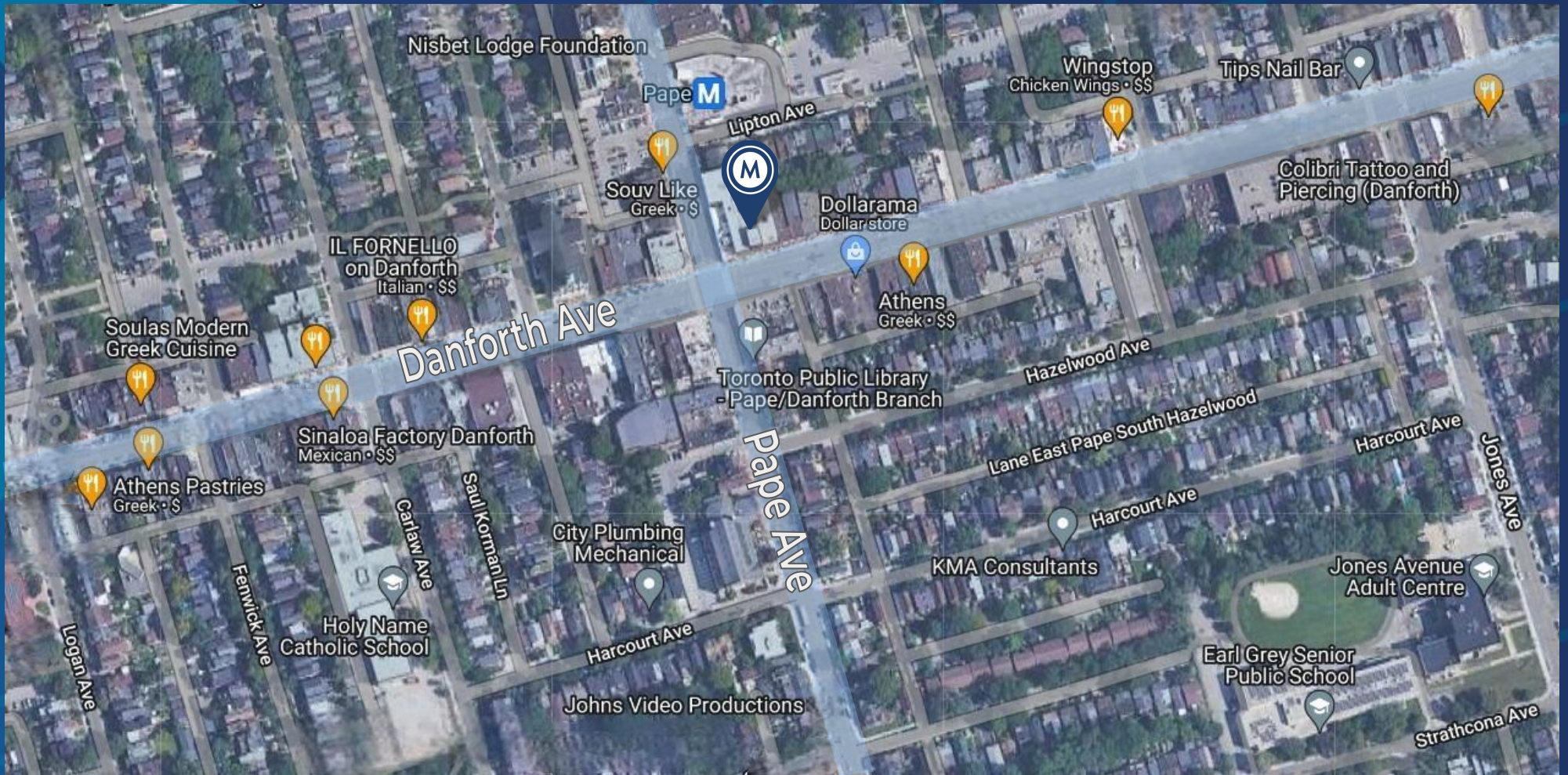

# CONNECTIVITY



BIKE SCORE OF 82

→ Biking is convenient for most trips



TRANSIT SCORE OF 91

→ World-class public transportation



WALK SCORE OF 99

→ Daily errands do not require a car



**METROPOLITAN  
COMMERCIAL**

## **CONTACT**

### **TIM NOVAK**

Senior Vice President

416.703.6621 x 246

[tim.novak@metcomrealty.com](mailto:tim.novak@metcomrealty.com)

150 Beverley St | Suite 1 Toronto, ON | M5T 1Y5

416.703.6621

[www.metcomrealty.com](http://www.metcomrealty.com)

The information contained herein has been gathered from sources deemed reliable. However, Metropolitan Commercial Realty Inc., Brokerage, its agents, or employees make no representations or warranties on the accuracy of said information. Prospective tenants and their agents are advised to independently verify any information provided herein. Metropolitan Commercial Realty Inc., Brokerage